

MODEL	OPERATING WEIGHT	SHIPPING WEIGHT
NCC-40	1390 LBS	1510 LBS
NCC-52	1460 LBS	1570 LBS
NCC-60	1745 LBS	1850 LBS
NCC-70	2035 LBS	2125 LBS

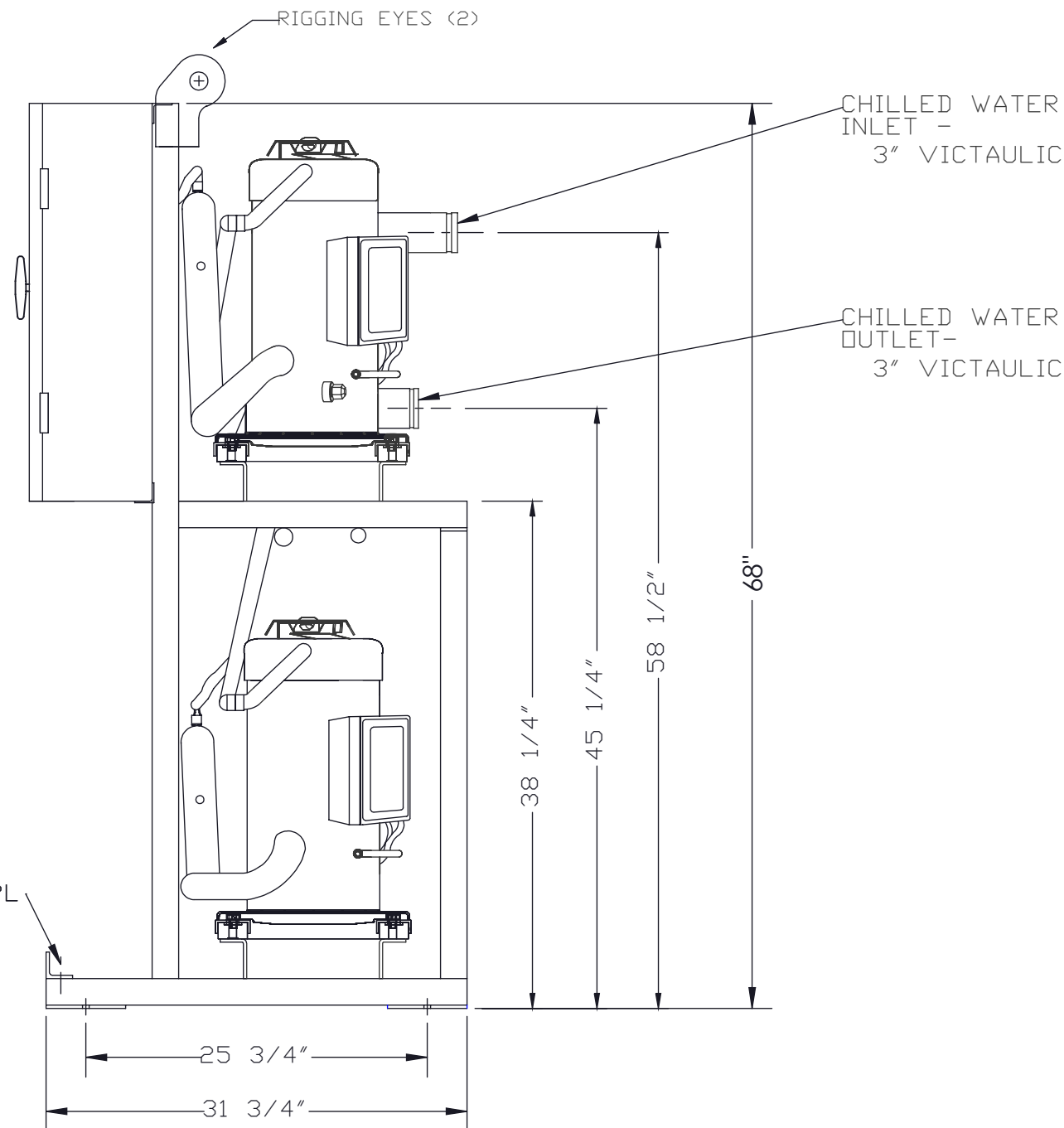
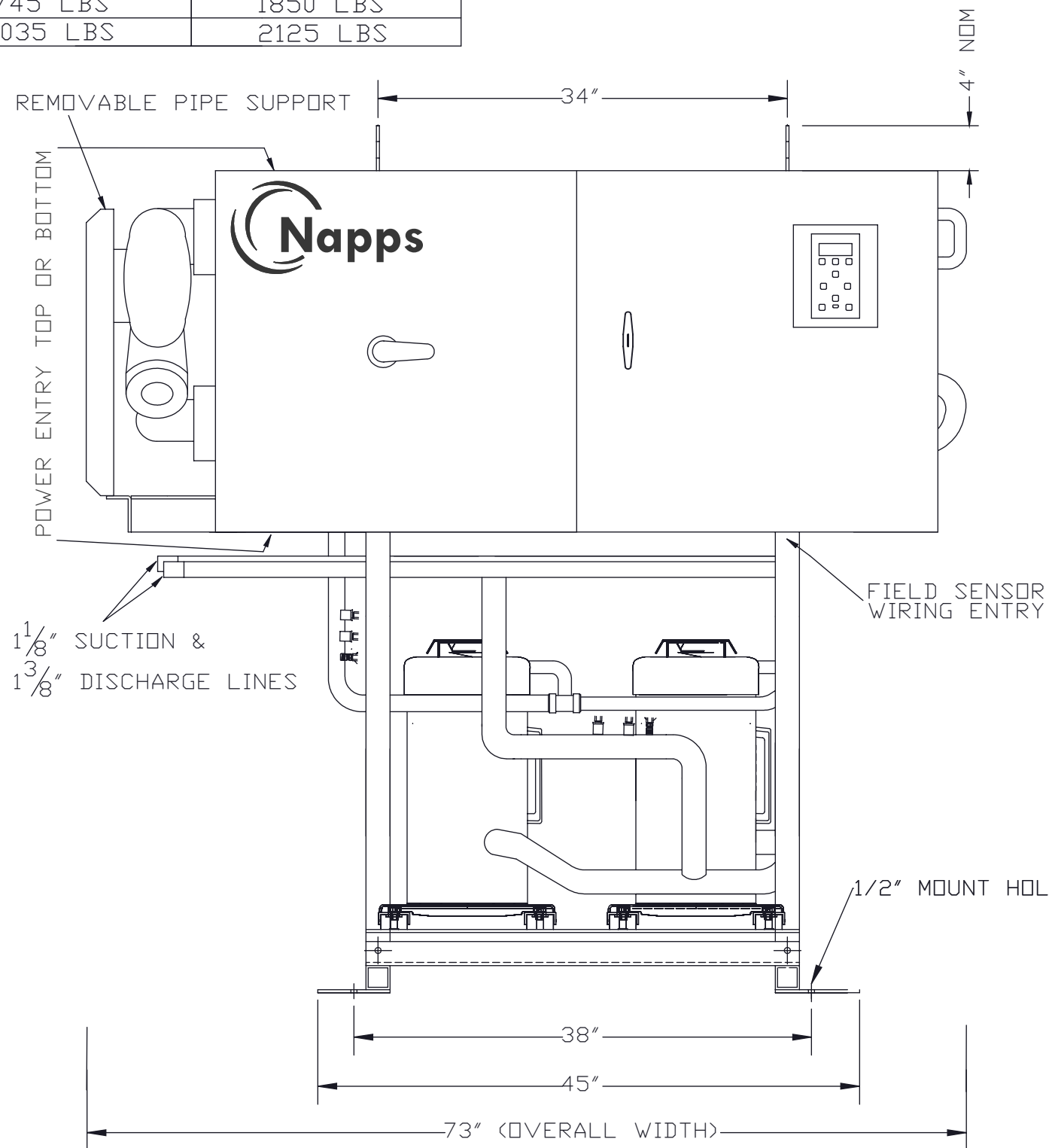

NOTES:

1. Allow 36" clearance on control box side for service.
2. Allow 24" min at rear to allow for service of compressors.
3. Allow 36" service clearance overhead.

IMPORTANT
 THE INFORMATION CONTAINED HEREIN, WHICH IS THE PROPERTY OF NAPP'S TECHNOLOGY CORPORATION, MUST BE MAINTAINED IN STRICT CONFIDENCE AND NO PORTION OF THIS MATERIAL MAY BE REPRODUCED OR USED FOR ANY PURPOSE WITHOUT THE EXPRESS WRITTEN CONSENT OF NAPP'S TECHNOLOGY CORPORATION

ENGINEER'S SEAL	BY	DATE	REVISION	NAPP'S TECHNOLOGY CORP. P.O. BOX 3066 LONGVIEW, TX 75606-3066 WWW.NAPPSTECH.COM			
	SMH	04-02-12	Corrected operating wts, added shipping wts & overhead clearance	TITLE: TYPICAL NCC 40,52,60,70 TON SCROLL COMPRESSOR CHILLER			
				SCALE: 1"=12"	DRAWN BY: AMS	CHECKED BY: PMK	APP'D BY: -
				R410A CHILLERS			B
				DRAWING NUMBER	REV. SHEET NO.	NAPP'S JOB NO.	
				NCC40526070	01 1 OF 1		